

**Social Transformations and Resilience  
Partnership  
Information Session  
30 January 2025**

---



# Agenda

1. Welcome & opening (10')

Barbara Kauffmann, Director for Employment and Social Governance, Analysis, DG EMPL, European Commission

Krzysztof Józwiak, Director, National Science Centre, Poland (NCN)

2. What is a European Partnership under Horizon Europe? 15'

Kathrin Kapfinger, DG RTD

3. Questions

4. Social Transformations and Resilience Partnership - setting the scene and overview of activities completed so far 10'

Malwina Gębalska, National Science Centre, Poland

5. Thematic overview and SRIA preparation 25'

Members of the STR Drafting Group: Tove Hammarberg, FORTE, Sweden; Grainne Walshe, Research Ireland; Francis Bloch, Ministry of Research and Higher Education, France; Francesca Rizzo, Ministry of Research, Italy; Christa Engel, DLR-PT, Germany

6. Next steps and discussion 60' (NCN)

# Q & A

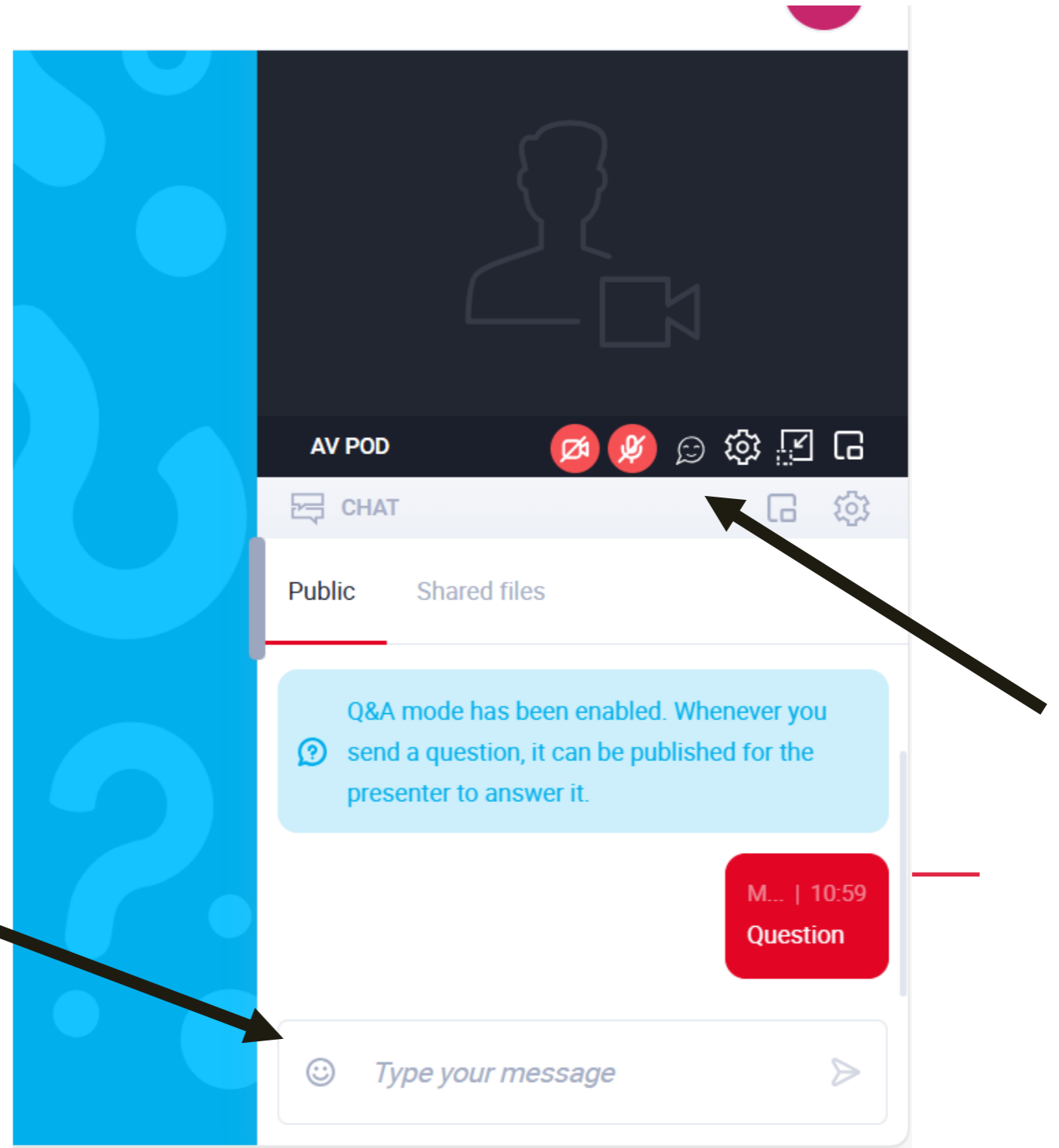

# What is a European Partnership under Horizon Europe?

Kathrin Kapfinger, DG RTD

---

# **Social Transformations and Resilience Partnership**

Malwina Gębalska, National Science Centre

---



# Rationale

- Major **social transformations**, brought by ecological, technological and demographic changes, coupled with a **heterogeneity in national policies and institutional settings** call for knowledge & resources sharing, **and long-term, concerted actions** between Member States, Associated Countries, and the EU, based on a joint vision and strategy.
- Fostering European cooperation and **breaking down fragmentation in the SSH field**.
- A co-funded partnership would contribute to **stronger ownership** at national and regional level and lead to improved **uptake of comparative and interdisciplinary R&I results among national authorities** and relevant stakeholders (e.g. social partners, social economy actors, civil society organisations)



## Description

- **Co-funded partnership** under Cluster 2 '*Culture, Creativity and Inclusive Society*' with the aim to:
  - Create a transformative R&I programme between **social sciences and humanities (SSH)** to build resilience, ensure fairness and inclusiveness and foster social cohesion in the light of changes in climate, environment, technology, demography and unexpected shocks.
  - Develop **knowledge, tools and innovative solutions** to address contemporary social challenges in a collaborative, interdisciplinary and systematic way.
  - Contribute to **new strategies and policy solutions** at European, national and regional level.



## Description

- **Expected partners:** Research funding organisations; Ministries and public national agencies in labour and social affairs/education/R&I
- **Coordinator:** National Science Centre (NCN) Poland
- **Envisioned duration:** 2027 – 2034 (possibly beyond)
- **Estimate total budget:** 100M – 120M EUR total (depending on MS contributions)





# European Partnerships – 2<sup>nd</sup> Strategic Plan 2025 - 2027

- 49 co-funded, co-programmed and institutionalised Partnerships launched under the first Strategic Plan 2021 – 2024.
- Commission proposed portfolio of 10 new partnership candidates for the second Strategic Plan in July 2023.
- **21 Member States and Associated Countries voted for inclusion of STR proposal as a “co-funded Partnership” in the Strategic Plan 2025 – 2027**
- STR Partnership aims for Cluster 2 Work Programme 2026



# Partnership landscape

## Cluster 1: Health

- Innovative Health Initiative
- Global Health EDCTP3
- Assessment of Risks of Chemicals (PARC)
- Transforming of Health Care Systems
- ERA for Health
- Rare Diseases
- One-Health Antimicrobial Resistance
- Personalised Medicine
- Pandemic Preparedness
- Brain Health

## Cluster 2: Culture, Creativity, Inclusive societies

- Resilient Cultural Heritage
- Social Transformations and Resilience

## Cluster 4: Digital, Industry and Space

- Chips JU
- Smart Networks and Services
- High Performance Computing
- European Metrology (Art. 185)
- Raw Materials for the Green and Digital Transition
- AI-Data-Robotics
- Photonics
- Made in Europe
- Clean Steel - Low Carbon Steelmaking
- Processes4Planet
- Globally Competitive Space Systems
- Innovative Materials for EU (I AM for EU)
- Virtual Worlds
- Textiles of the Future

## Cluster 5: Climate, Energy and mobility

- Clean Hydrogen
- Clean Aviation
- Single European Sky ATM Research 3
- Europe's Rail
- Clean Energy Transition
- Driving Urban Transition
- Connected, Cooperative and Automated Mobility
- Batteries
- Zero-Emission Waterborne Transport
- Zero-Emission Road Transport
- Built4People
- Solar Photovoltaics

## Cluster 6: Food, bioeconomy, natural resources, agriculture and environment

- R&I in the Mediterranean Area (PRIMA) (Art. 185)
- Circular Bio-based Europe
- Biodiversa+
- Blue Economy
- Water4All
- Animal Health and Welfare
- Accelating Farming Systems Transformation
- Agriculture of data
- Safe and Sustainable Food Systems
- Forests and Forestry for a sustainable Future

■ Institutionalised partnerships (Art. 185/7, EIT KICs)

■ Co-funded partnerships

■ Co-programmed partnerships

■ Proposed new candidate European Partnerships under the 2nd Strategic Plan 2025-2027



# Process 2024

- **Jan 2024:** A core group of representatives from national funding bodies and Ministries started working on developing a full draft proposal with support from a preparatory action, led by the ZOE-Institute for Future-fit Economies and EIT Climate-KIC.
- **Feb – Oct. 2024:** 4 participatory meetings to co-create a common **vision** for the Partnership with interested Member States and Associated Countries; look at the **research gaps and trends**, and explore the **activities** with researchers, social partners, civil society actors and other stakeholders. Final workshop on **governance models**.
- **Q4 2024 – Q1 2025:** Core group is finalising the draft proposal.

**CORE GROUP:** Belgium, France, Germany, Ireland, Italy, Poland, Sweden and the European Commission

# Thematic overview and SRIA preparation

---



# Social protection and essential services

- European welfare states are all facing similar challenges: **increase in demand, rising costs, fragmentation and inequalities in access.**
- Social protection (**'cash'** side) and essential services (**'care'** side) are interacting sides of the welfare system.
- Social protection and essential services systems need to be **sustainable, adaptable, and capable of fulfilling their purpose** and handle both **long-term challenges and occasional shocks** that will differ in type and effect from time to time.



# Social protection and essential services

## Research approaches and themes

- More integrated and dynamic research approaches as well as a focus on problem solving.
- Research of how social policy can be used to increase resilience and reduce inequalities in peoples' wellbeing; how to ensure inclusiveness and accessible social protection and essential services systems.
- In order to contribute to new solutions there is a need for both reappraisal and reviews of established principles, such as the concept of "universality" or "insurance".
- Stability and effectiveness of the social security systems as well as the sustainability of the financing and taxation models.



# Fostering education and skills development

## Context

- **Focus on education and skills development for young adults and adults**, in order to support them through the green and digital transitions and to deal with the challenges of demographic change.
- **Fostering societal resilience** through education and skills to deal with societal shocks will be threaded through these.
- Aligned with this, research and innovation into **lifelong learning models** are essential, with the ongoing and impending job destruction in certain areas and job creation in others
- Supporting disadvantaged groups (low-income background, migrants, disability, ageing and rural disability) to access and remain in education and training



# Fostering education and skills development

## Green and digital transition

- Development of STEM and ICT skills, literacy & capital for women and disadvantaged groups, as well as transversal skills (problem-solving, communication, creativity)
- Skills intelligence and anticipation tools in the context of the evolving labour market
- Examine the effectiveness of education systems, including vocational education and training

## Demographic change

- Analyse labour and skills shortages and horizontal segregation, and support citizens to upskill and reskill at all stages in life
- Explore theoretical understandings, policies and initiatives to promote the 'right to training', especially for persons in precarious situations
- Effects of demographic change on education and training systems





# Fostering education and skills development

## Resilience to unexpected shocks

- Fostering entrepreneurial and transversal skills for all, e.g., systems thinking, creativity, fusion of arts-making and scientific-based experimentation
- Strengthen critical thinking and information literacy in strengthening resilience to disinformation as well as education for citizenship
- Enhance public-private collaboration, including by incentivising and enabling enterprises to utilise workers' skills through innovative workplace solutions



# Future of work

## Three transitions

- Digital transition and role of AI
- Green transition and greening of jobs
- Demographic transitions and new work cycles

## Issues and gaps in research

- New work organizations, work quality and well being
- Access to jobs, functioning of the labor markets
- Social cohesion and inequalities



# Fair transition towards climate neutrality

## Background

How to balance the green transition impacts on people life to avoid social conflicts may aggravate in the course towards decarbonisation risking a breakdown of social cohesion.

## Research topics and gaps for future research

- Conceptualising fairness
- Attitudes, values and lifestyles
- Building trust and legitimacy
- Climate policy instruments and frameworks
- Systemic design approaches
- Democratization of the green transition
- Green-digital nexus



# Strategic Research and Innovation Agenda (SRIA) - next steps and opportunity to engage

**DLR Projektträger, Germany**





# The Foresight Process

DLR, on behalf of HERA, will conduct a foresight process for preparing the SRIA for STR: 1 vision, 4 themes, 1 SRIA.

## The elements

- Desk research
  - including scoping potential experts (research, civil society, policy, administration...)
- Surveys
- Expert interviews
- Workshops
- Synthesis reports
- An online community platform (*under construction*)
- An email-box: STR-Foresight@dlr.de



# Strategic Foresight-Cycles



Visioning-Process



Trendanalysis



Szenario- development



Backcasting



**Formulation of the SRIA**

- Strategic Research and Innovation Agenda (SRIA) for 2027-2033
- Anticipation of key challenges, definition of research lines & measures to translate research into policy



# Developing the Strategic Research and Innovation Agenda for STR: The way ahead





# STR Foresight Platform

Start February 2025

## Features

- Info on STR Partnership
- Foresight process with input loops
- Event organisation
- Individual profiles



STR-  
Foresight@dlr.de

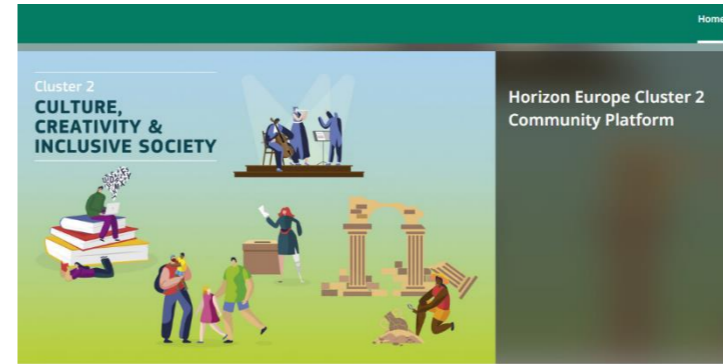

Info How it works Presentations Event archive FAQ Contact

Welcome to the  
Net4Society Cluster 2 Community Platform  
The Community Platform is open all year round and offers you the chance to...  
for all upcoming Cluster 2 calls.



Examples of partnering platforms in the European Research Area





# How to engage

## Be informed

- Keep track of the development of STR via the STR foresight platform!

## Show yourself

- Set up your profile on the platform! Let us know your interest in activities!

## Spread the news

- Share the platform with your ecosystem!

## Participate

- Give your input in our surveys (4 in 2025, one per theme)!

## Share expert suggestions!



**Social Transformations and Resilience**  
**Partnership – next steps**  
Malwina Gębalska, National Science Centre



# Call for proposals

**At least 6 calls for proposals are expected within the partnership duration**

- Call for projects involving, as a standard, 3 entities per project independent legal entities from two different EU Member States or Horizon Europe associated countries
- Call open for at least 2 months
- Standard Horizon Europe award criteria: excellence; impact; and quality and efficiency of the implementation
- 2-step selection procedure



# Potential additional activities

- **Strategic development** of the Partnership (including update of **SRIA** and collaboration with EU missions, Partnerships and European Social Fund)
- Supporting **cross-project collaboration & exchange** between funded consortia and **relevant stakeholders**
- Reinforcing the link between R&I projects and **research infrastructures**
- Training and promotion of **open research, open data and data accessibility**
- **Uptake** of research results and increasing impact of R&I programmes and projects, connecting researchers with **stakeholders and citizens**
- Supporting the development of **evidence-based public policies** and strategies
- **Capacity building & Widening**, including alignment with national agendas and stakeholder groups



# Timeline

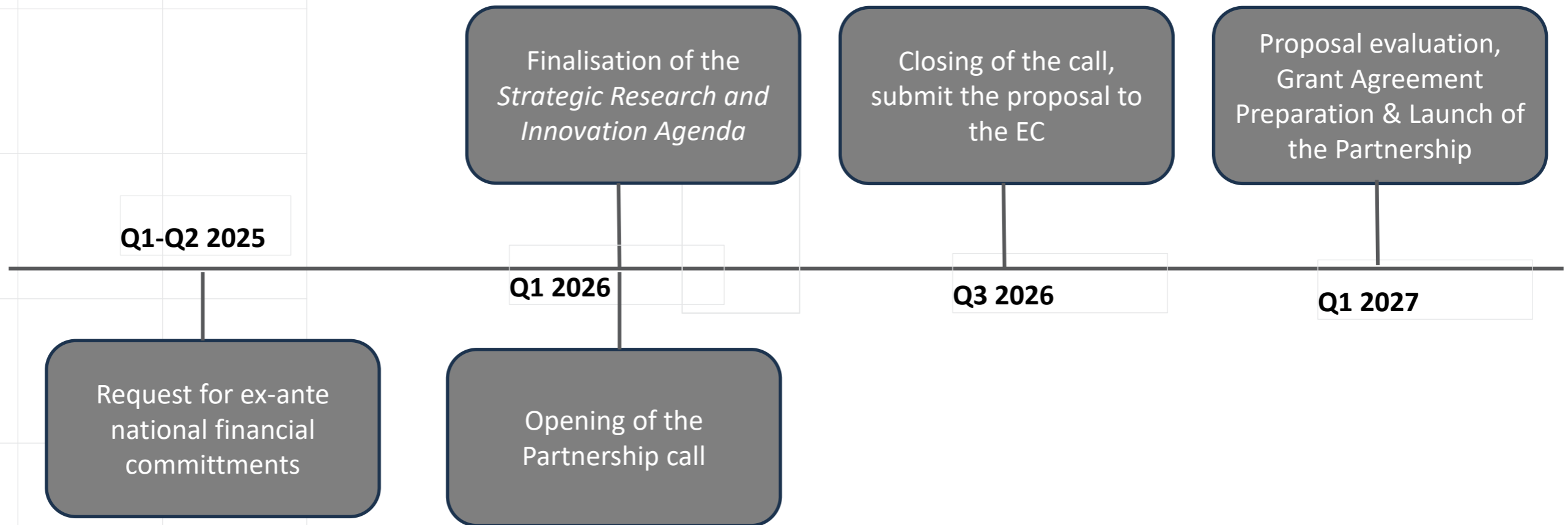



# Partner organisations (1)

Signatories of the Grant Agreement with the EC	
<b>National/regional research funding organisations and ministries funding research</b>	<ul style="list-style-type: none"><li>- Launching calls for proposals, funding research projects, monitoring research project implementation</li><li>- Participating in additional activities, including WP and task leaders roles (depending on available resources)</li></ul>
<b>Sectoral ministries and other public organisations in strategic roles</b>	<ul style="list-style-type: none"><li>- Giving strategic advice,</li><li>- Allocating funding for the calls</li><li>- Participating in additional activities, including WP and task leaders roles (depending on available resources)</li></ul>



## Partner organisations (2)

Signatories of the Grant Agreement with the EC	
<b>Other relevant partners: universities, NGOs, associations, private companies <u>depending on activities planned</u></b>	<ul style="list-style-type: none"><li>- Participating in additional activities, including WP and task leaders roles (depending on available resources)</li></ul>
<b>Service providers</b>	<ul style="list-style-type: none"><li>- Providing IT services, communication, etc.</li><li>- Media companies</li></ul>



# Financial commitments

Request for financial commitments sent by Commissioner for start-ups, research and innovation to Permanent Representations of Member States and Associated Countries – Q1 2025

We will participate in the partnership	Yes <input type="checkbox"/>	No <input type="checkbox"/>	Undecided <input type="checkbox"/>
Lead Ministry at national level [organisation, name, position, e-mail address]			
Indicative commitments for the full duration of the initiative [in € million]			
Financial contributions			
Contributions to additional activities <sup>2</sup>			
Comments			





# How to calculate your financial commitment

**Based on your national experience with SSH funding opportunities, consider the following:**

- What is the average budget for your national team in transnational projects?
- How many projects do you expect to fund per call?
- What are the needs and potential of your research community in the partnership impact areas?



# How to calculate your financial commitment

## Keep in mind that:

- The average budget for a transnational project in:
  - ERA-NET Cofund calls (e.g. CHANSE, HERA, and NORFACE) amounts to EUR 1.5–2 million across all partners
  - similar partnership calls (DUT/Biodiversa+): EUR 1-2 million across all partners
- Duration: max. 36 months
- The estimated contribution of Member States and Associated Countries to the STR Partnership is min. EUR 70 M in total (i.e. 70% of the total estimated budget)
- It is expected that a minimum of 6 calls will be organised within the partnership, next to additional activities.

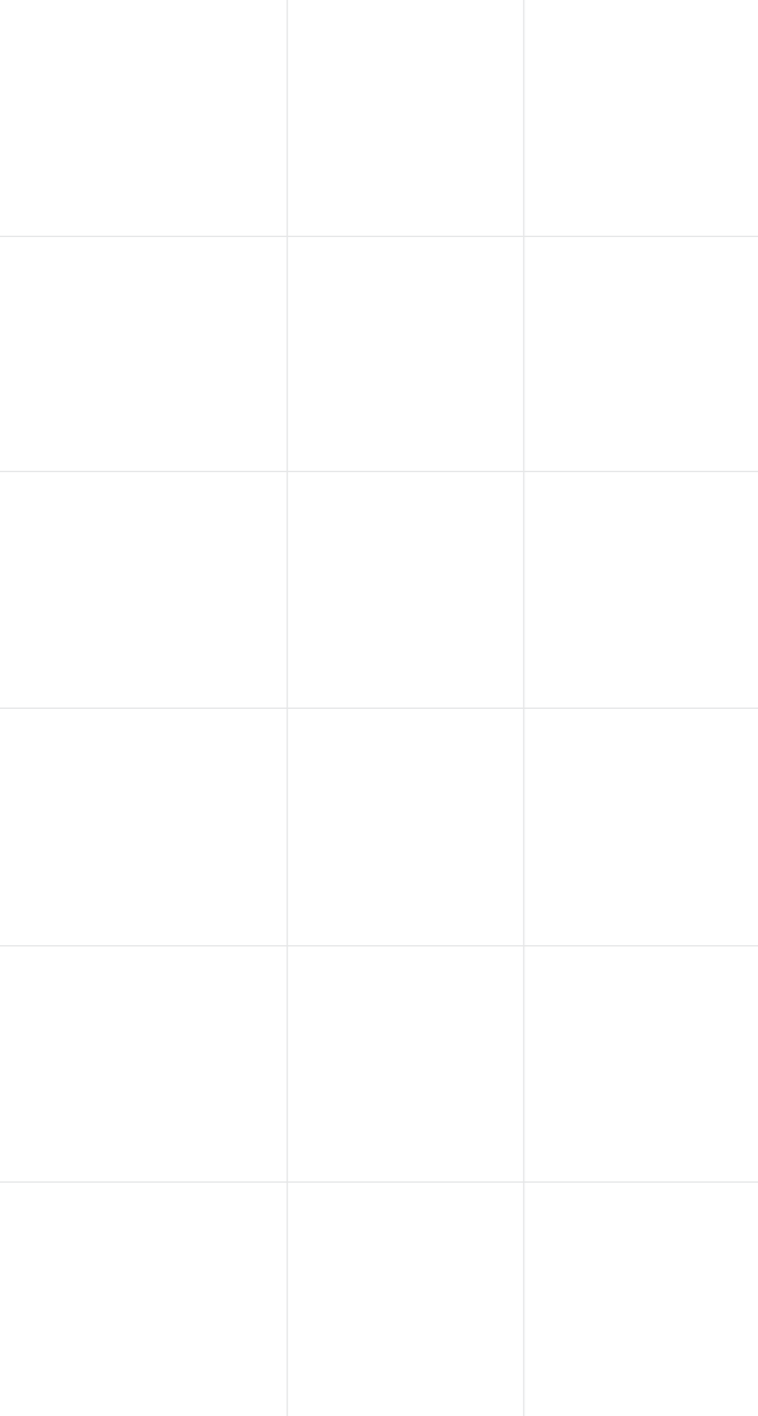

**How to get involved?** \_\_\_\_\_



# National consultations for STR

- Reach out to national/regional funding organisations
- Map your national research communities
- Consult national/regional stakeholders (e.g. sectoral ministries, NGOs, associations)
- Identify national/regional programmes within the STR impact areas
- Consult with national/regional stakeholders involved in European Partnerships



# Partnership formation – timeline for 2025

## Beneficiaries of the Grant Agreement level

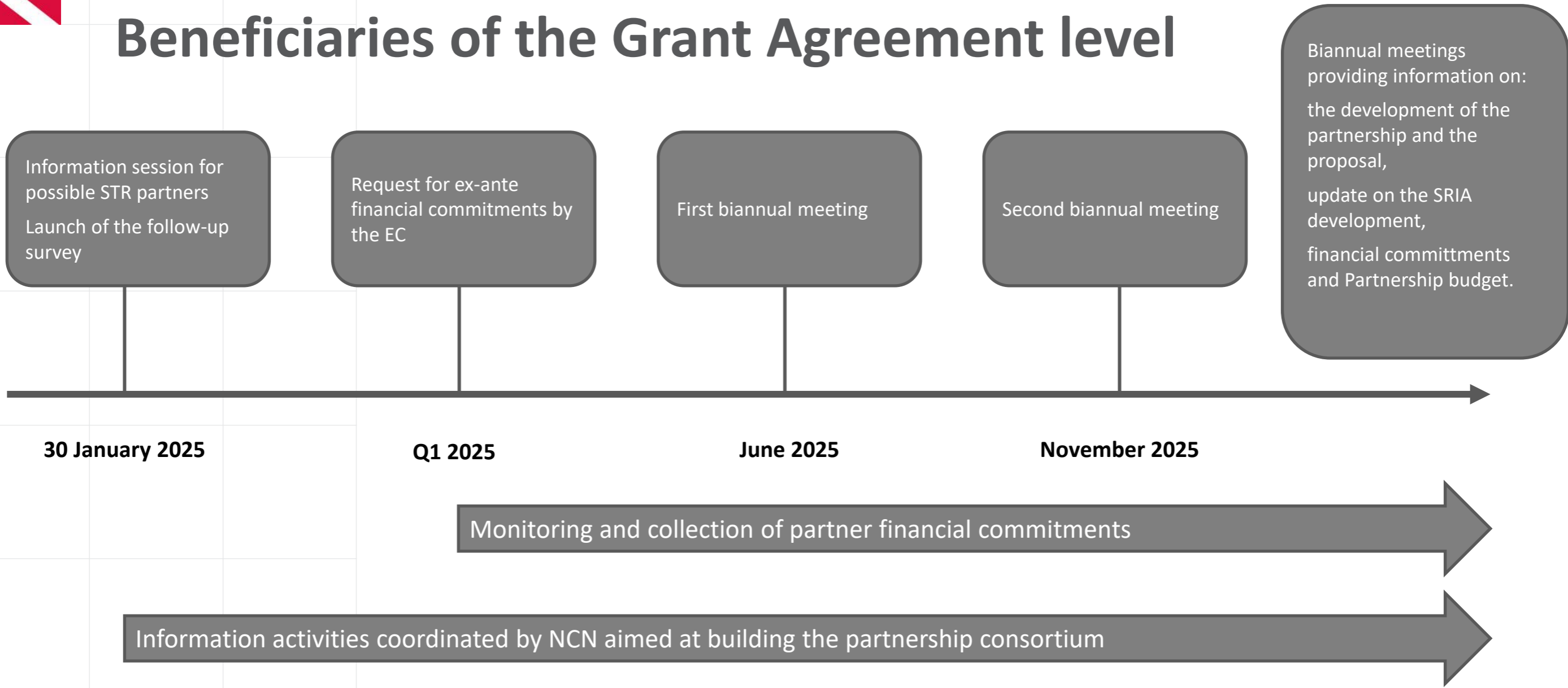



# Partnership formation – timeline for 2025 STR Roadmap of Actions (2027-34) level

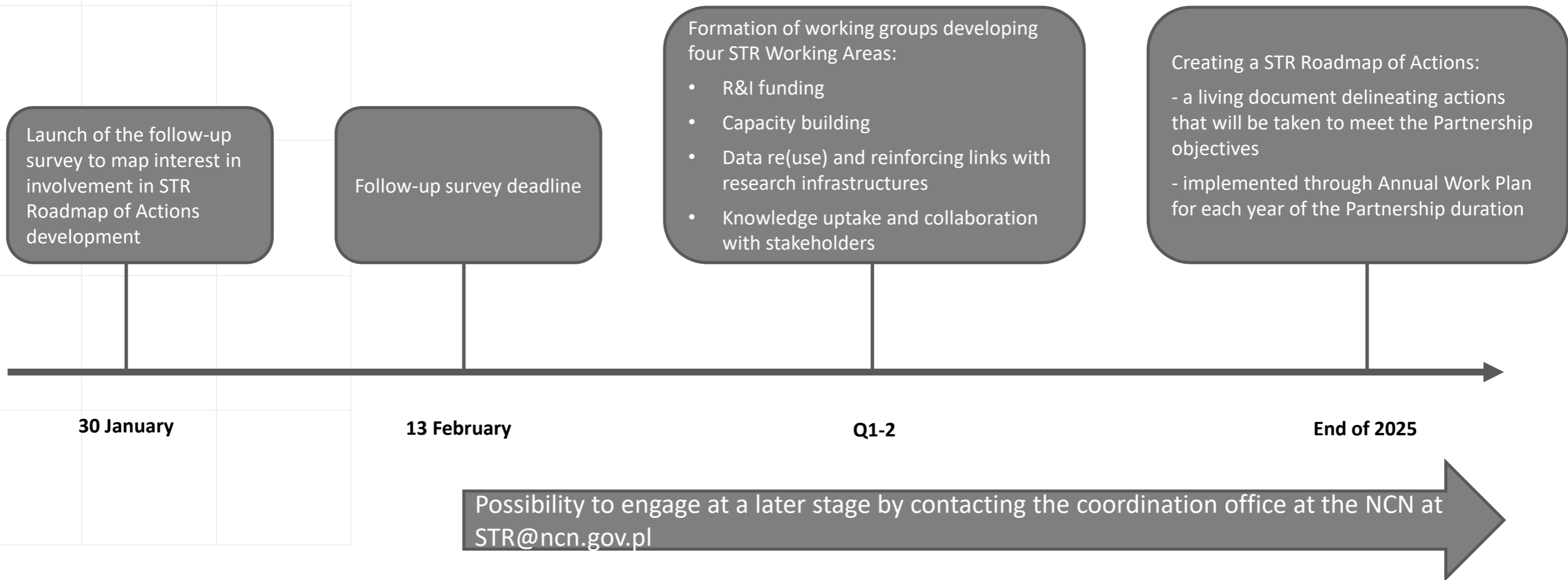



# Focus on creating a roadmap of actions

## STR Roadmap of Actions 2027-2034

- A living document delineating actions that will be taken to meet the Partnership objectives
- It will be implemented through Annual Work Plan for each year of the Partnership duration



# Working Areas – activity examples

R&I Funding
Organisation of annual joint calls for proposals
Monitoring and promoting the results of funded projects
Pilot call(s) for proposals co-created in dialogue with policy and other stakeholders

Capacity Building
Mapping of needs and target groups
Training activities
Facilitating connections and collaborations across disciplines, sectors & countries
Activities dedicated to early career researchers
International collaboration
Supporting Widening and less performing countries, including national mirror groups & alignment with national agendas





# Working Areas

<b>Data (re)use and reinforcing links with research infrastructures</b>
Mapping of existing infrastructure
Facilitate networking and engaging with existing infrastructures
Provide training on FAIR data expertise
Investigate data policy requirements and potential barriers for data sharing and accessibility

<b>Uptake of knowledge and collaboration with stakeholders</b>
Mapping of stakeholders relevant for the impact areas
Activities facilitating exchange with potential stakeholders
Facilitate learning opportunities on how to engage with stakeholders
Support the development of evidence-based public policies and strategies

# Follow-up survey and next steps



# Follow-up survey

The survey will be conducted following the info session on 30 January 2025

COUNTRY	
INSTITUTION	
Name of the contact	
Email address	
Do you plan to participate in the European Partnership on Social Transformations and Resilience (STR)?	Yes/No
Do you plan to provide financial (cash) contributions for the joint calls (no. of calls and any other details to be decided among the partners at a later stage)?	Yes/No
If yes, please give an estimate of the indicative financial commitment for the full duration of the initiative [in € million]	- €



# Follow-up survey – leadership role (1)

Would you be willing to lead a work package or task related to the following areas?  
(If yes, please specify by selecting WP or Task Leader):

- **Call Secretariat:** organisation of the proposal submission and evaluation process
- **Funded project monitoring** & organisation of exchange between funded consortia and relevant stakeholders
- **Communications and promotion** of the Partnership activities and projects' results



## Follow-up survey – leadership role (2)

Would you be willing to lead a work package or task related to the following areas?  
(If yes, please specify by selecting WP or Task Leader)

- **Strategic development of the Partnership** (including update of **SRIA** and collaboration with EU missions, Partnerships and European Social Fund)
- Reinforcing the link between R&I projects and **research infrastructures**
- Training and promotion of **open research, open data and data accessibility**
- **Uptake of research results** and increasing impact of R&I programmes and projects, connecting researchers with stakeholders and citizens
- Supporting the development of **evidence-based public policies** and strategies
- **Capacity building & Widening**, including national mirror groups & alignment with national agendas
- **International Cooperation**



# Discussion

Please share your views on your interest and potential involvement in the Partnership

- STR impact areas
- Participation in calls
- Potential financial and in-kind commitment
- Role of the Work Package or task leader
- Interest in additional activities

# Discussion

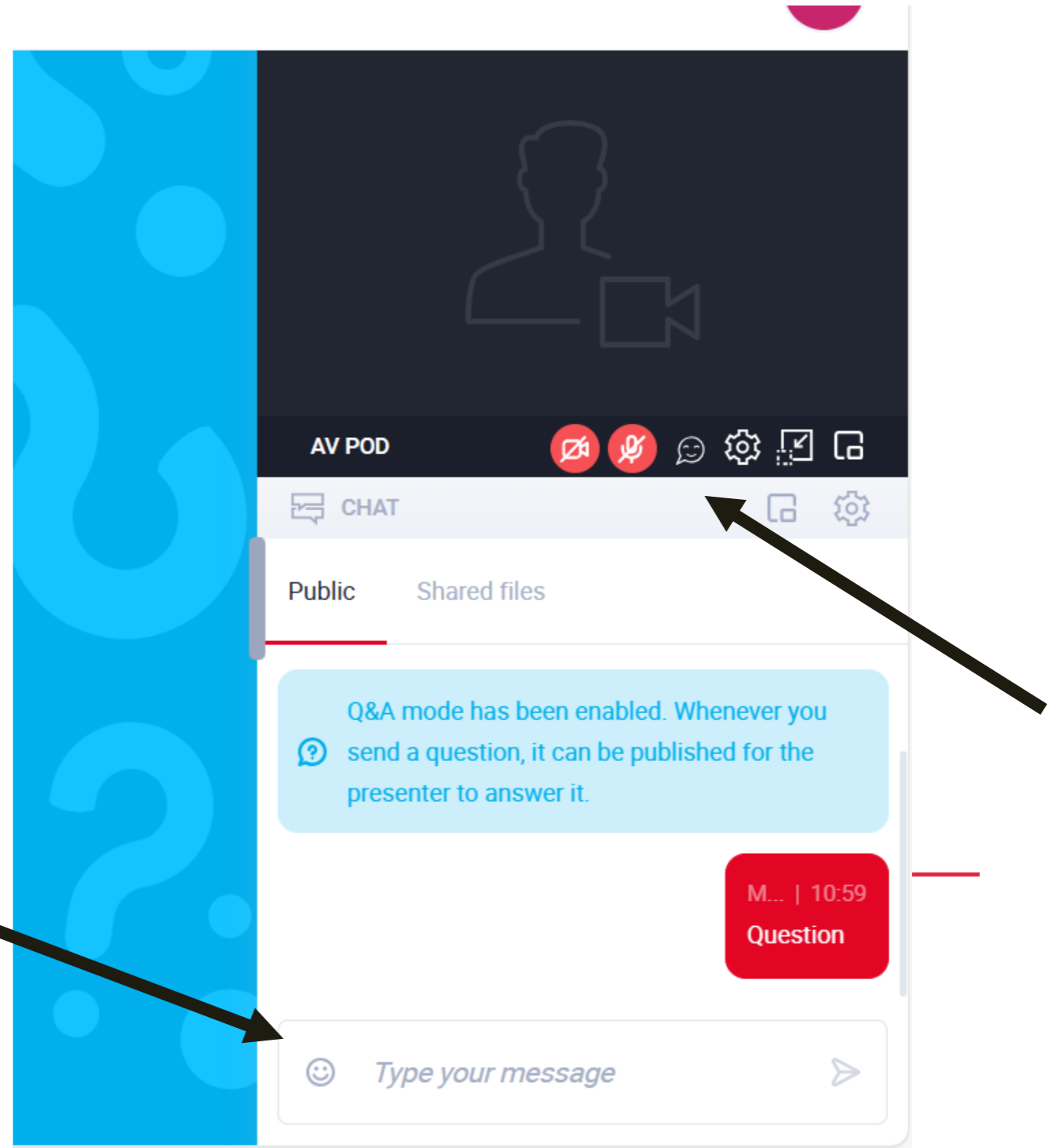



**Thank you for your attention  
– dziękuję!**





**Contact**  
[STR@ncn.gov.pl](mailto:STR@ncn.gov.pl)

**More information**

[Social Transformations and Resilience Partnership candidate – CHANSE](#)